

The S3Max is an intermediate system between the Eraser and the Super Eraser that features a 10" tall blade. It is ideally suited for more aggressive applications where a larger blade is required, or those systems with a larger head pulley.

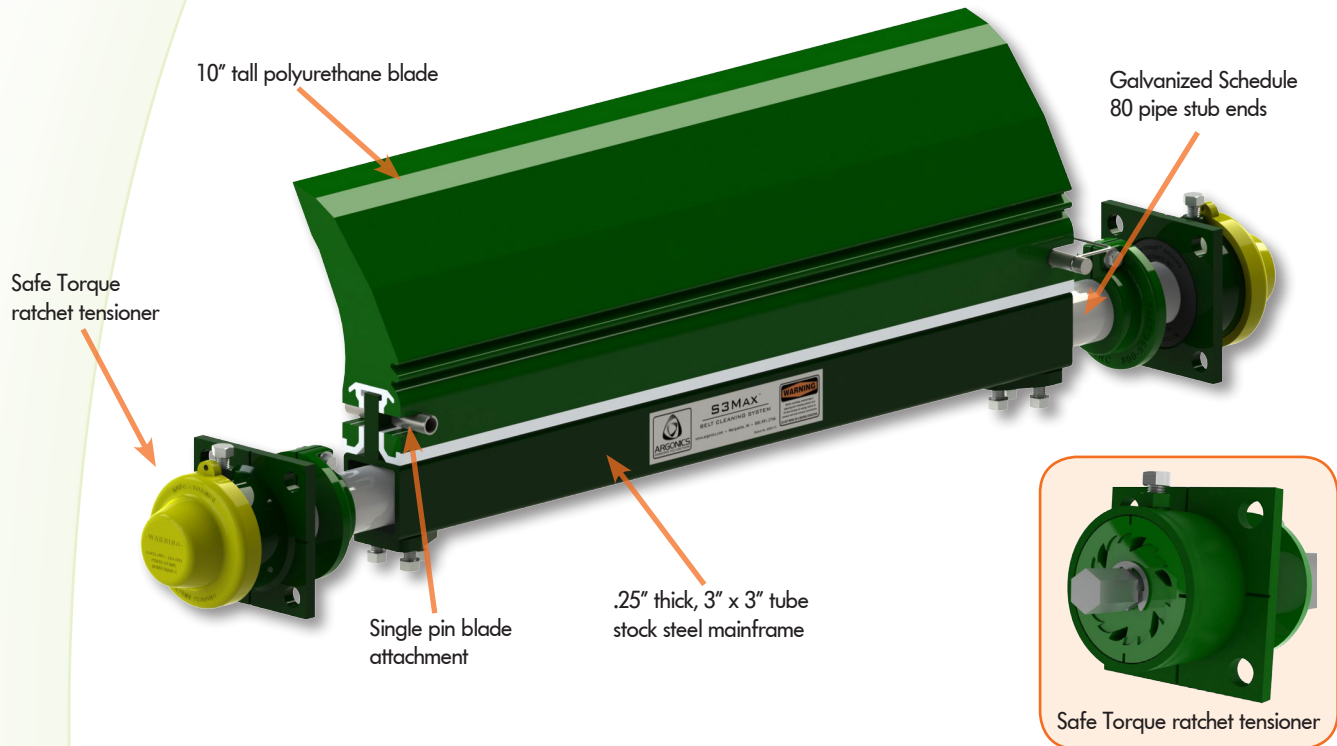

## BENEFITS

- Effective cleaning performance with a 10" (254 mm) tall Raptor blade
- Ideally suited for more aggressive applications
- No rusted springs, hoses, cables, shocks or mud-packed components to deal with
- The Perma-Torque™ tensioner provides uniform cleaning pressure and superior cleaning performance
- Brightly colored, safety yellow end caps seal the Safe Torque™ ratchet from dust and water contamination
- Single pin blade attachment means quick and simple blade change out with less downtime
- A wide variety of configurations as well as complete stainless steel systems are available

## BLADES

- |  |   |
|--|---|
| <p><b>N62 Ether</b><br/>Normally used for extremely wet applications, sands &amp; fines</p>  | <p><b>B93 Ester</b><br/>Our high temperature cleaning blade, up to 250°F (121°C)</p>  |
| <p><b>R80 Ether</b><br/>Good for wet applications with any pH level</p>                      | <p><b>FO83 Ester</b><br/>MSHA approved Front Line® flame-retardant cleaning blade</p> |
| <p><b>G83 Ester</b><br/>Our standard, high abrasion-resistant all-purpose cleaning blade</p> | <p><b>RU83 Ester</b><br/>Flame retardant, anti-static cleaning blade</p>              |
| <p><b>U90</b><br/>Good for dry applications with any pH level</p>                            |   |



## SIZING INFORMATION

Dimensions - in. (mm)

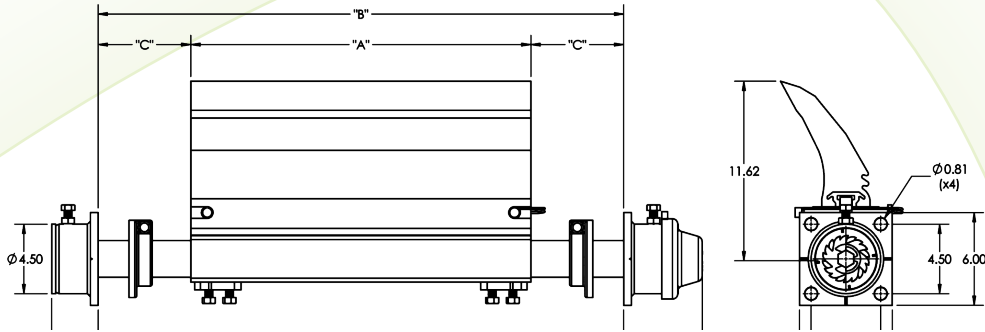

Part Number	A		Min B.		Max B.		Min C.		Max C.		Shipping Weight	
	inches	(mm)	inches	(mm)	inches	(mm)	inches	(mm)	inches	(mm)	lbs	(kg)
CP-S3M-A22M-G83	22.00	(559)	22.50	(572)	38.00	(965)	0.25	(6)	8.00	(203)	80.50	(37)
CP-S3M-A28M-G83	28.00	(711)	28.50	(724)	44.00	(1118)	0.25	(6)	8.00	(203)	89.25	(40)
CP-S3M-A34M-G83	34.00	(864)	34.50	(876)	50.00	(1270)	0.25	(6)	8.00	(203)	97.75	(44)
CP-S3M-A40M-G83	40.00	(1016)	40.50	(1029)	56.00	(1422)	0.25	(6)	8.00	(203)	106.75	(48)
CP-S3M-A46M-G83	46.00	(1168)	46.50	(1181)	62.00	(1575)	0.25	(6)	8.00	(203)	120.00	(54)
CP-S3M-A52M-G83	52.00	(1321)	52.50	(1334)	68.00	(1727)	0.25	(6)	8.00	(203)	131.50	(60)
CP-S3M-A58M-G83	58.00	(1473)	58.50	(1486)	74.00	(1880)	0.25	(6)	8.00	(203)	140.25	(64)

### NOTES:

- To get minimum B or C, the shaft collars must be removed.
- For extended tensioner, add 14" (356 mm) to B max. and 7" (178) to C max.
- Standard "in stock" sizes shown above. Other sizes are available from 22" (559 mm) to 96" (2438 mm).

## SPECIFICATIONS

### Recommended Belt Speeds

500 - 800 fpm (2.54 - 4.06 m/s)

### Pulley Diameter (PD)

Minimum: 24" (610 mm)

Maximum: 48" (1219 mm)

## NOMENCLATURE

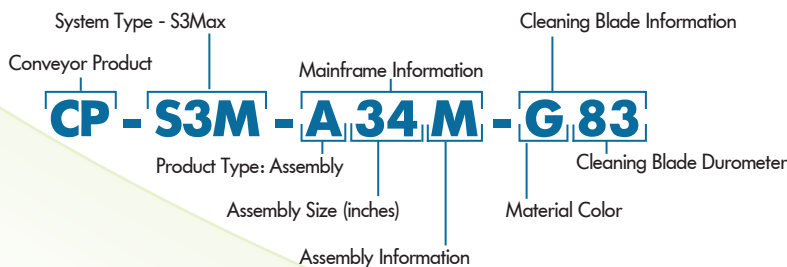

### Notes:

Stainless steel systems are available. Contact your Argonics rep. for more information.

## MOUNTING INFORMATION

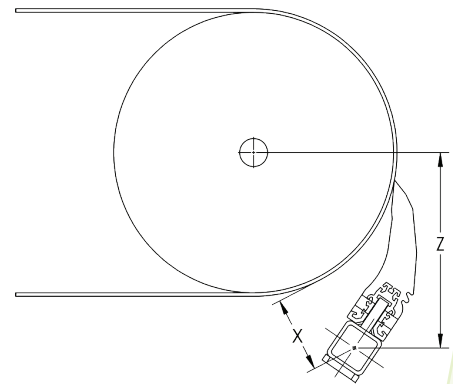

Pulley Diameter	X	Z
24" - 27" (610 mm - 686 mm)	4.75" (121 mm)	12.75" (324 mm)
28" - 31" (711 mm - 787 mm)	4.5" (114 mm)	12.75" (324 mm)
32" - 48" (813 mm - 1219 mm)	4.25" (108 mm)	12.75" (324 mm)



**ARGONICS**  
ENGINEERED POLYURETHANE



Jamieson Equipment Company  
www.jamiesonequipment.com  
toll free 800.875.0280